

Star Illustration and Parts List

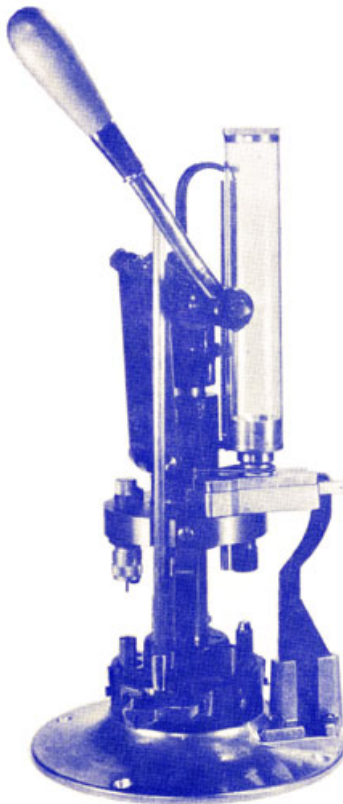

THE STAR RELOADING TOOL
FOR PISTOL AND REVOLVER



THE STAR LUBRICATOR
AND RESIZER
RESIZING AND LUBRICATING IN
ONE-THIRD THE USUAL TIME

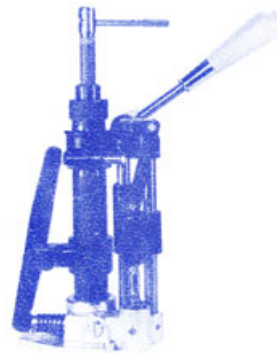

STAR MACHINE WORKS
OF SAN DIEGO, INC.
418 Tenth Avenue – San Diego, California 92101

THE STAR RELOADER

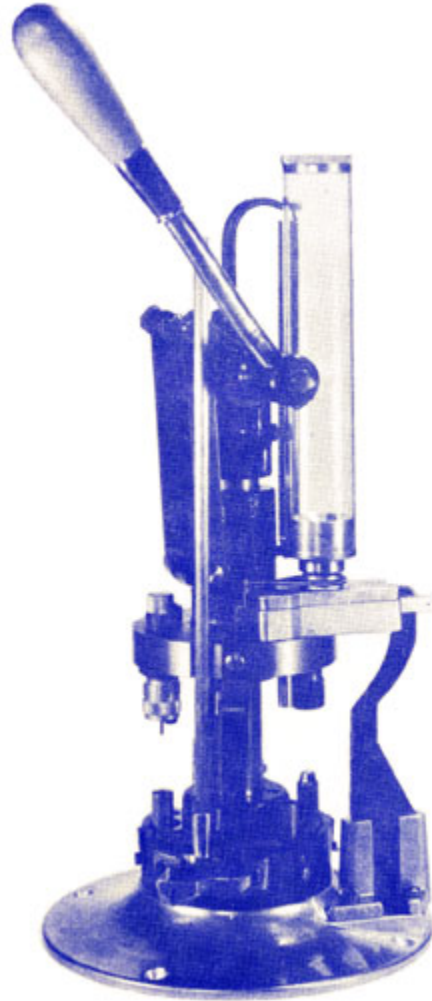

OPERATION

In the PROGRESSIVE RELOADING TOOL a complete reload is made in one stroke of the hand lever and by handling the shell only once. In stability of continuous operation it is unsurpassed by any loader in the field. The powder carrier has passed the closest inspection and throws as accurate a charge as can be metered. All tools and dies are adjustably mounted in a tool head, performing their operations on the shells in their respective positions simultaneously. Its name, PROGRESSIVE RELOADING TOOL, is derived from its method of operation, progressively reloading shells from one stroke of the hand lever, a complete load to each stroke.

LEADERSHIP

THE PROGRESSIVE RELOADING TOOL was originally designed and patented by us and has been the accepted leader in its field for over 50 years. Only a few minor changes have been made since the original model was placed on the market due to the soundness of the fundamental design and the accuracy with which each part is made. Its acceptance by leading pistol and revolver shooters is based on excellence of performance and trouble free operation.

THE PROGRESSIVE RELOADER is manufactured complete in our own well-equipped shop, by our specially trained mechanics. When we state that it will last a lifetime, we mean just that. We have testimonial letters on file that have been sent to us voluntarily and many of these tools have reloaded over one million shells.

THE STAR LUBRICATOR and RESIZER

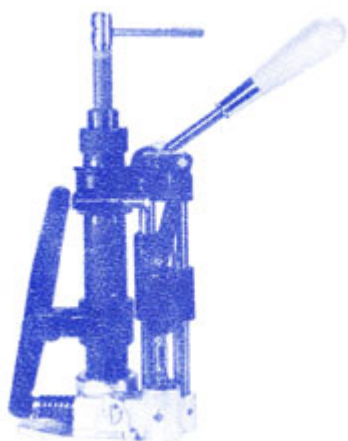

OPERATION

This lubricator embodies a newly perfected method of lubricating bullets; is substantially and carefully built and is accurate and positive in its operations. A storage pressure system is used in the grease reservoir, by means of a compression spring, which feeds the grease to a high-pressure pump which automatically forces the lubricant into the grooves of the bullet. The bullet is then forced through the die by the entering of the next one.

One setting of the pressure screw greases from 100 to 200 bullets. The bullets being forced on through the die makes this tool about three times as fast as the ordinary lubricator.

This tool is becoming as famous as the PROGRESSIVE RELOADING TOOL among shooters for its accuracy and speed. It is equipped with hardened dies and is adaptable to any caliber. It is sold on a money back guarantee if not satisfactory after a week's trial.

IMPORTANT

In ordering send us one of YOUR bullets and the tool will be properly adjusted before being shipped to you. Or if no bullet is available give description or catalog number.

OWNERSHIP AND GUARANTEE

THE STAR RELOADING TOOL is sold on an unconditional money-back guarantee. Use the tool for one week and if you are not more than satisfied notify us that you are returning it and we will refund your purchase price. The only expense to you will be the transportation one way. If the tool has been abused and needs repairs, we will charge for same. We have been selling this reloading tool for over 50 years under this money back guarantee and have not been asked for a refund up to this time.

IMPORTANT ORDERING INFORMATION

The reloader parts are illustrated in two columns in order to distinguish the relative positions of the many parts.

The parts terminating with the letter "U" fit the Universal or adaptable tool only. All other parts are interchangeable. For example, the steel floor base for the .38 caliber tool is #12. Same part for the Universal or adaptable tool is #12U. Buller seater #20 is for the 38 and 32 caliber and #20U is for larger calibers which would be used on the Universal tool.

The Universal Reloader is distinguished from the Progressive Reloader by three No. 79U Shell Base Locating Straps on the Steel Floor Base and Powder Slide Housing marked OO.

All parts terminating in an asterisk (*) should be assembled at our factory where we have the necessary jigs and tools. #49 may be installed by purchaser, but will need to be fitted.

To adjust: Bend part #49 toward column shaft or vice versa until primer slide stops gently against the column shaft when the tool head is at the bottom of its travel.

When ordering #71 or #27 specify "O" (1/4 inch thick) or "OO" (5/16 inch thick), give description of powder and number of grains desired.

When ordering dies and bullet punches for the Lubricator and Resizer specify maker's name of mould and bullet number of send sample bullet.

Specify all details, including desired caliber, when ordering parts whose dimensions are determined by caliber.

If numerous parts of your tool are worn, we suggest sending it to us for an estimate on rebuilding it.

Progressive Reloading Tool, w/Carbide Resizing Die, .38 special only. This tool will not adapt to load other calibers or the .38 Auto rimless. (Specify bullet number and powder charge.)

Approximate shipping weight – 27 lbs.

Universal Reloading Tool, w/Carbide Resizing Die. This tool will adapt to the popular hand gun calibers. We stock those parts necessary to load the 45 ACP and the 38 special. Approximate shipping weight – 27 lbs.

Extra Tool Head Tooled for one caliber, includes shell plate, w/Carbide Die for Universal Reloader only.) Approximate shipping weight – 8 lbs.

Set of Dies (to convert universal to load another caliber): Consists of 1 ea., #13 Shell Plate, #15c and #19 Carbide Resizing Die and Nut, #16 and #17 Shell Expander Plug and Nut, #18 and #19 Crimping Die and Nut, #20 and #69 Bullet Seater and Nut, and #27a Powder Slide. Note this does not include Tool Head. These dies must be installed by you in your Tool Head.

STAR RELOADING TOOL ILLUSTRATION AND PARTS LIST

Refer to ordering instructions before selecting parts.

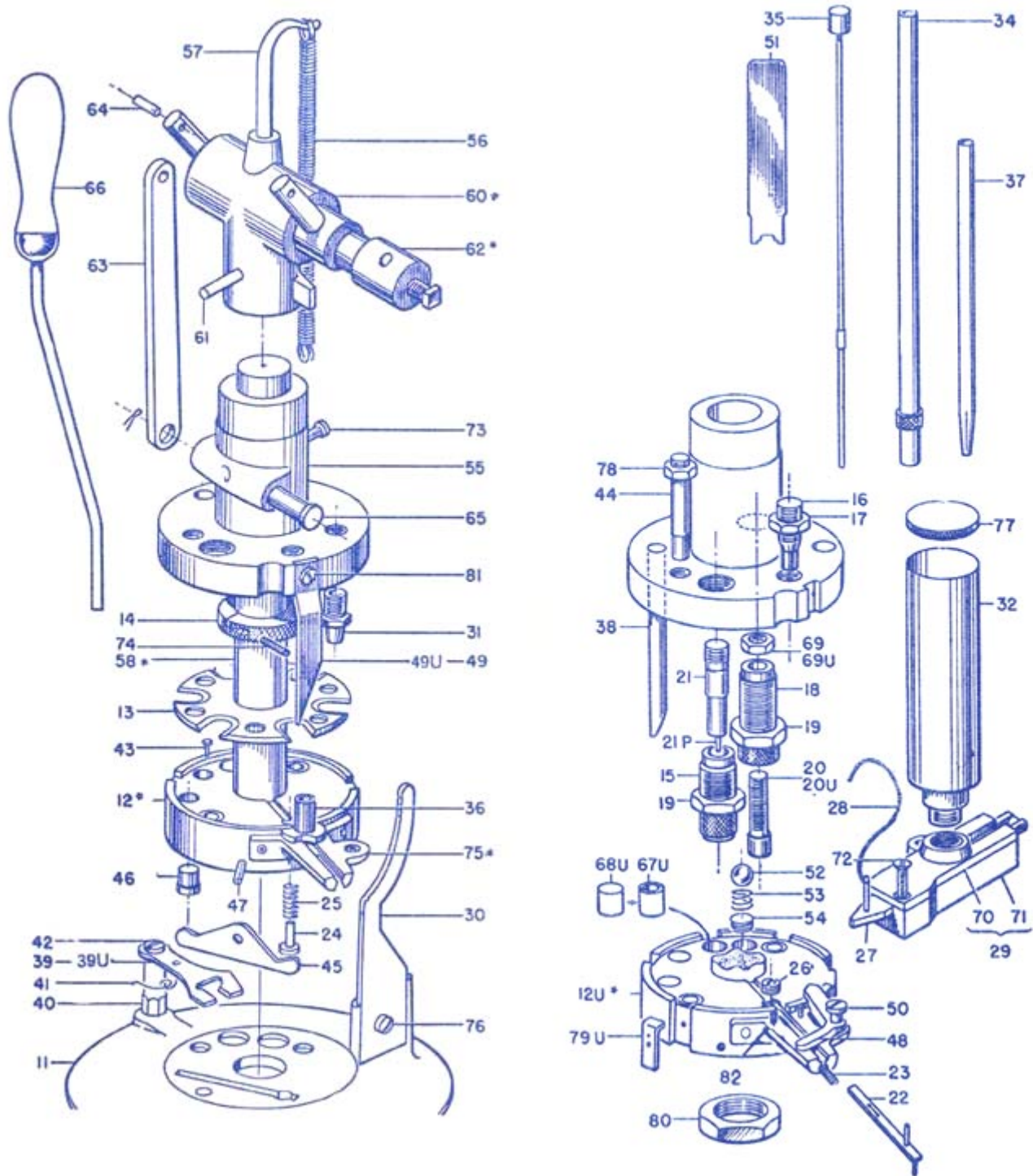

STAR RELOADING TOOL PARTS LIST

Part No.			
11	Aluminum Base.....	40	Safety Cam Standard.....
12*	Steel Floor Base.....	41	Safety Cam Spring.....
12U*	Steel Floor Base.....	42	Safety Cam Screw.....
13	Shell Plate.....	43	Safety Cam Stop Pin.....
14	Shell Plate Thrust Nut.....	44	Primer Punch Push Rod.....
15	Shell Resizing die, Steel (includes de-capping pin assembly) ..	45	Primer Punch Rocker Arm.....
15C	Shell Resizing Die, Carbide (includes de-capping pin assembly) ..	46	Rocker Arm Tappet.....
16	Shell Expander Plug.....	47	Rocker Arm Screw.....
17	Shell Expander Plug Nut.....	48	Primer Slide Angle Lever.....
18	Crimping Die.....	49	Angle Lever Cam.....
18T	Taper Crimp Die For 38 SPL. and 45 ACP 11/16"x24" threaded.....	49U	Angle Lever Cam.....
19	Crimping Die Nut.....	50	Angle Lever Screw.....
20	Bullet Seater (Send sample bullet).....	51	Primer Punch Bushing Screw Driver.....
20U	Bullet Seater (Send sample bullet).....	52	Steel Ball.....
21	Decapping Pin Assembly (Steel die--specify caliber).....	53	Steel Ball Spring.....
21C	Decapping Pin Assembly (Carbide die--specify caliber).....	54	Steel Ball Plug.....
21P	Decapping Pin for Regular or Carbide Die (pkg. of 6).....	55	Tool Head.....
22	Primer Slide (Specify large or small).....	56	Tool Head Spring.....
23	Primer Slide Spring.....	57	Spring Anchor or Goose Neck.....
24	Primer Punch (Specify make and size of Primer, whether oval or flat).....	58*	Column Shaft.....
25	Primer Punch Spring.....	60*	Crank Shaft Bearing.....
26	Primer Punch Bushing (Specify large or small).....	61	Taper Pin.....
27	Powder Slide No. O -- 1/4" Thick for the Progressive Reloader only. Max. capacity 5.0 gr. B.E. or 5.9 gr. Unique.....	62*	Crank Shaft Assembly.....
27A	Powder Slide No. OO -- 5/16" Thick for the Universal Reloader only. Max. capacity 7.0 gr. B.E. or 8 gr. Unique or 11 gr. #2400.....	63	Links, each.....
27B	Powder Slide -- 1/2" Thick for the Universal Reloader only. Max. capacity 14.0 gr. Unique, 18.0 gr. #2400.....	64	Upper Link Pin, each.....
27C	Powder Slide -- 5/8 Thick for the Universal Reloader only. Max. capacity 23.0 gr. #2400. *Housing Spacers, set -- 3/16" Thick for 1/2" Slide or 5/16" for 5/8".....	65	Lower Link Pin.....
28	Powder Slide Spring.....	66	Crank Shaft Handle.....
29	Powder Slide Housing (Specify No. O or OO).....	67U	Shell Floor Base Bushing.....
30	Powder Slide Cam.....	68U	Shell Floor Base Plug.....
31	Powder Measure Spout (Specify caliber).....	69	Bullet Seater Nut.....
32	Powder Magazine (Complete).....	69U	Bullet Seater Nut.....
34	Primer Magazine Tube (Specify large or small).....	70	Powder Slide Housing Cover Plate.....
35	Primer Follower Rod.....	71	Powder Slide Housing Base (Specify No. O or OO).....
36	Primer Magazine Socket.....	72	Powder Slide Housing Screw.....
37	Primer Pick-up Tube (Specify large or small).....	73	Tool Head Spring Anchor Screw.....
38	Shell Plate Dowel Pin.....	74	Shell Plate Thrust Nut Clamping Screw.....
39	Safety Cam.....	76	Powder Slide Cam Screw.....
39U	Safety Cam.....	77	Powder Magazine Cap.....
		78	Primer Punch Push Rod Nut.....
		79U	Shell Base Locating Strap.....
		80	Column Shaft Nut.....
		81	Angle Lever Cam Clamping Screw.....
		82	Primer Magazine Socket Screw.....
		83	Allen Wrench for Decapping Pin.....
		84	Allen Screw for Decapping Pin.....

STAR LUBRICATOR AND RESIZER ILLUSTRATION AND PARTS LIST

Refer to ordering instructions before selecting parts.

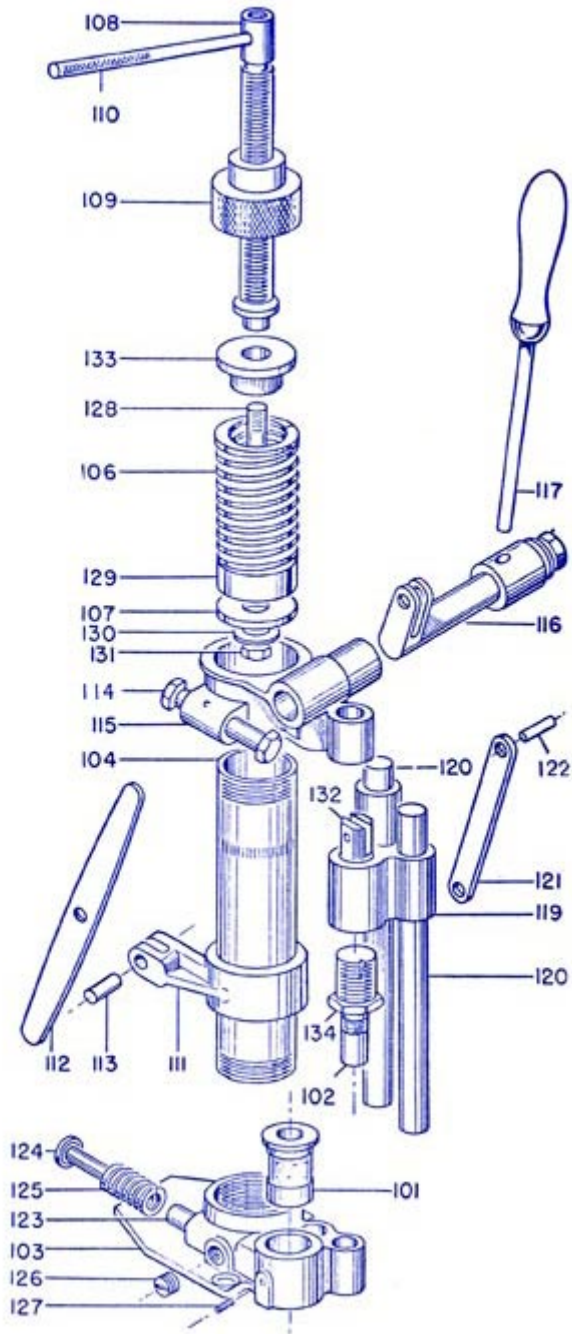

STAR LUBRICATOR AND RESIZER PARTS LIST

Part No.	
101	Dies, all popular calibers, send sample bullet and state size of die wanted or number of bullet and size of die wanted. (Tool steel only. Carbide not supplied.) Die extractor for part 101, makes removal of die from lubricator much easier and faster when changing from one caliber to another.....
102	Bullet Punch (same information as part 101), Bullet followers to protect the nose of pointed bullet when Sizing and Lubricating
103*	Base Casting
104*	Grease Cylinder
105	Pressure Spring Assembly (consists of No.'s 106, 107, 128, 129, 130, 131, and 133).....
106	Pressure Spring
107	Hycar Washer
108	Pressure Screw.....
109	Pressure Screw Nut
110	Pressure Screw Handle
111*	Fulcrum Lever Bracket.....
112	Fulcrum Lever
113	Fulcrum Lever Pin.....
114	Fulcrum Lever Push Rod Assembly (Consists of 2 No. 135's and Push Rod).....
115*	Crank Shaft Bearing
116	Crank Shaft Assembly
117	Crank Shaft Handle.....
118	Handle (Clamp) Screw.....
119*	Bullet Punch Ram
120*	Ram Guide Column, Each
121	Ram Link.....
122	Link Pin (Upper or Lower), Each.....
123*	Pump Guide Bushing
124	Pump Plunger
125	Pump Spring
126	Inspection Plug
127	Die Set Screw
128	Pressure Spring Piston Rod
129	Pressure Spring Steel Piston.....
130	Pressure Spring Steel Washer.....
131	Pressure Spring Hycar Piston Screw.....
132	Ram Link Crosshead
133	Pressure Spring Thrust Collar.....
134	Bullet Punch Nut
135	Bolt
38	Shell Plate Dowel Pin

* PARTS NO.'S 103, 104, 111, 115, 119, 120, 123, AND 132 SHOULD BE ASSEMBLED AT OUR FACTORY WHERE WE HAVE THE NECESSARY JIGS AND TOOLS.

NOTE: STAR MACHINE WORKS OF SAN DIEGO, INC is no longer in business. This document will not be updated for current suppliers or parts cost. Please consult the website and discussion forum resources for any items you may need.